

Brass T2 Sconce



WAL-050



# Brass T2 Sconce



WAL-050

### DESCRIPTION

An upgraded version of our original Brass T sconce. Featuring a seamless machined-brass body, with blown-glass globes instead of bare bulbs.

### MATERIALS

Brass, Glass

### METAL FINISHES

Available in All Standard Metal Finishes

### GLASS FINISHES

Alabaster, Matte White, Opal

### MOUNTING HARDWARE DIAGRAM

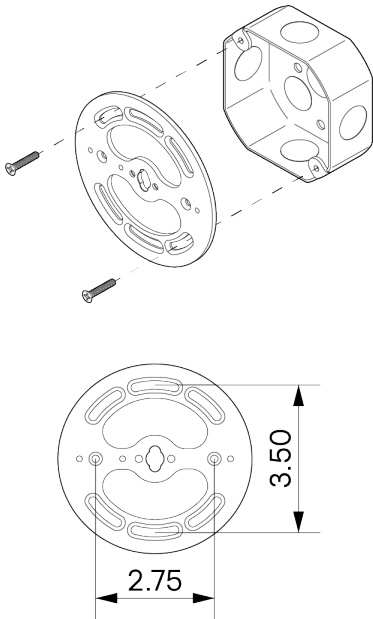

### MOUNTING

Universal

### WEIGHT

4.5 lb

### LAMPING

G8 Bi-Pin Base. Type T Lamps

### BULB INCLUDED (120V USA)

Emery Allen 4.5W G8 Bulb

### BULB INCLUDED (240V EU)

Emery Allen 4.5W G8 240V Bulb

### LAMP QUANTITY

2

### BRIGHTNESS

900 Lumens

### DIMMING

LED+

### DIMENSIONAL DRAWING

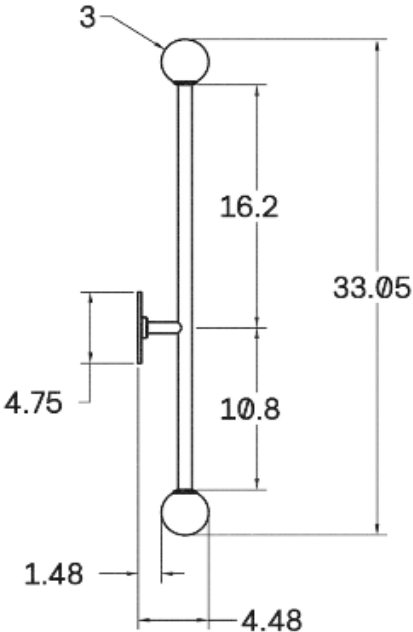

### CERTIFICATIONS

CE, Damp Locations, Outdoor and Wet Locations, UL and cUL Certified

