

Half Dome Pendant 14"



CEI-050



Half Dome Pendant 14"



CEI-050

DESCRIPTION

This hand-spun 14" dome is meticulously brushed and waxed to a matte satin finish. Accented with a wooden finial, and suspended with 6' of field adjustable cord. UL Certified.

MATERIALS

Brass, Glass, Wood

METAL FINISHES

Available in All Standard Metal Finishes

GLASS FINISHES

Clear, Frosted, Matte White, Opal, Smoked

WOOD FINISHES

Available in All Standard Wood Finishes

MOUNTING HARDWARE DIAGRAM

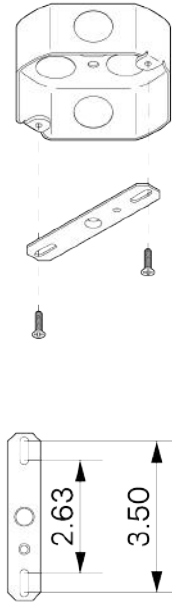

LAMPING

E26 or E27 Screw Base. Type A Lamps

BULB INCLUDED (120V USA)

Cree 60W Bulb

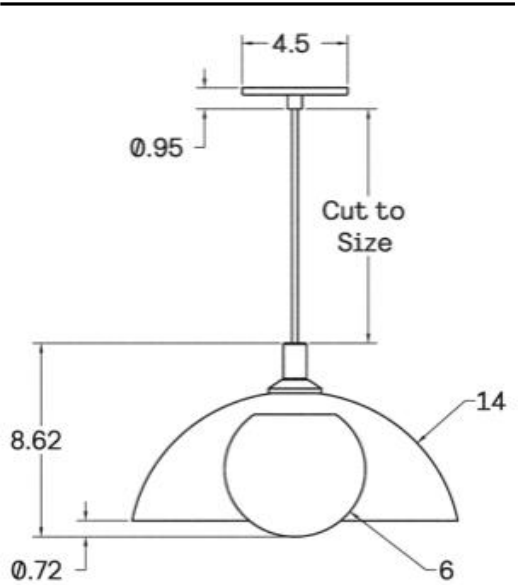

MOUNTING

Universal

WEIGHT

9 lb

DIMENSIONAL DRAWING

CERTIFICATIONS

CE, Damp Locations, UL and cUL Certified

