

Monoscope Sconce 10"



WAL-076



Monoscope Sconce 10"



WAL-076

DESCRIPTION

The Monoscope collection is an expression of simple yet richly textured geometry. Hardwood veneer is wrapped over an Aluminum LED core and diffused by borosilicate glass, and brass fittings. These materials are brought together by a skilled artisan to form an incredibly well diffused and bright lighting fixture. Monoscope is not only beautiful but extremely functional. Its light fills the room thanks to the disc shaped shade that illuminates brightly on both sides; bouncing against the ceiling while providing direct illumination below.

MATERIALS

Aluminum, Brass, Glass, Wood Veneer

METAL FINISHES

Blackened Brass, Brass, Bronze, Gradient, Maker Black, Nickel, Raw Brass, Sandblasted Grey, Stonewashed Brass, Verdigris

WOOD FINISHES

American Oak, Available in All Standard Wood Finishes, Walnut Burl

MOUNTING HARDWARE DIAGRAM

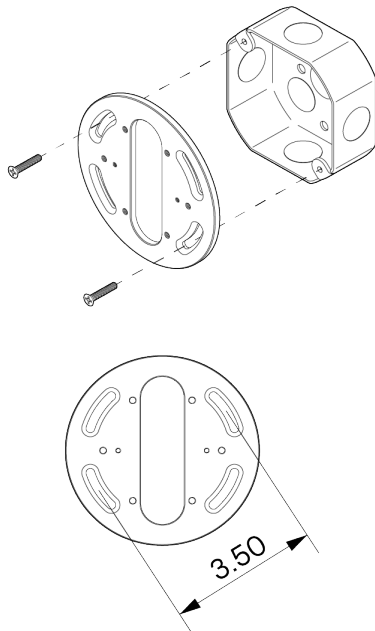

LAMPING

Integrated Low Voltage LED with Driver Included

LAMP QUANTITY

2

BRIGHTNESS

2200 Lumens

DIMMING

0-10V, Universal

DIMENSIONAL DRAWING

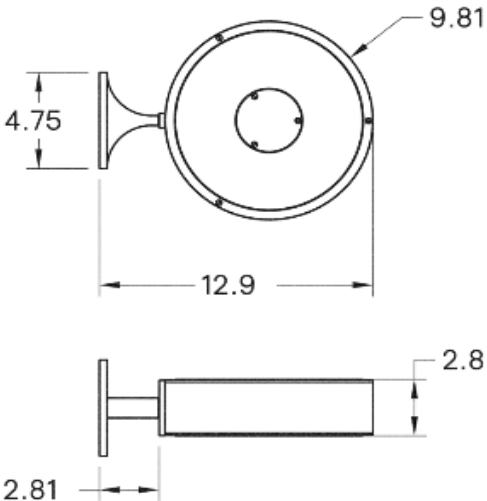

MOUNTING

4" J-Box only. Minimum 1.25" depth

WEIGHT

19.5 lb

CERTIFICATIONS

CE, Damp Locations, UL and cUL Certified

