

Orb Sconce



WAC-036



Orb Sconce



WAC-036

DESCRIPTION

This simple surface mount features a 7" diameter glass globe. The globe is mouth-blown from artisans in Vermont and features bespoke brass hardware that allows for easy bulb access with a twist off assembly. The cast brass backplate and neck offer a seamless look that hides all hardware. Available in all of our handcrafted finishes.

MATERIALS

Brass, Glass

METAL FINISHES

Available in All Standard Metal Finishes

GLASS FINISHES

Matte White, Opal

MOUNTING HARDWARE DIAGRAM

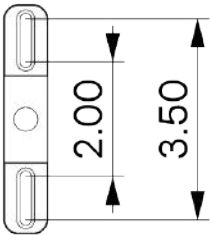
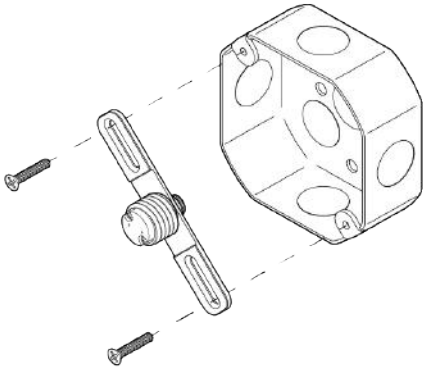

LAMPING

G8 Bi-Pin Base. Type T Lamps

BULB INCLUDED (120V USA)

Emery Allen 7W G8 Bulb

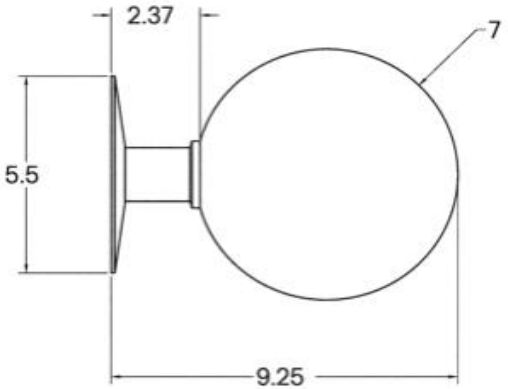

MOUNTING

Universal

WEIGHT

3 lb

DIMENSIONAL DRAWING

CERTIFICATIONS

CE, Damp Locations,
Outdoor and Wet
Locations, UL and cUL
Certified

