

## Union Pendant



CEI-141



# Union Pendant



CEI-141

### DESCRIPTION

A ceiling pendant with seamlessly joined woodblocks and blown-glass globe lights at the ends. Time-honored Japanese joinery techniques ensure a tight and long-lasting fit on the wood body, and the five globes provide a bright and well-diffused spread of light.

### MATERIALS

Brass, Glass, Wood

### METAL FINISHES

Available in All Standard Metal Finishes

### GLASS FINISHES

Alabaster, Matte White, Opal

### WOOD FINISHES

Available in All Standard Wood Finishes

### MOUNTING HARDWARE DIAGRAM

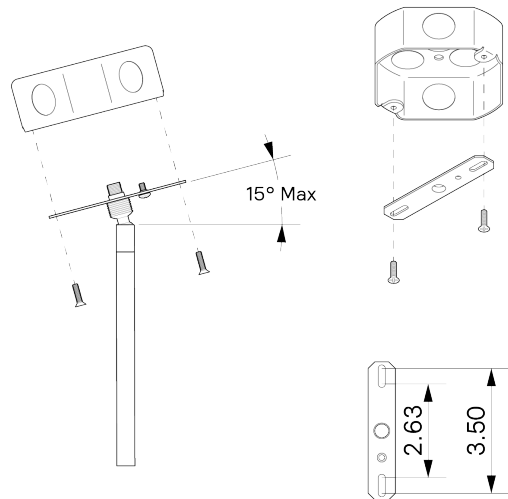

### LAMPING

G8 Bi-Pin Base. Type T Lamps

### BULB INCLUDED (120V USA)

Emery Allen 4.5W G8 Bulb

### BULB INCLUDED (240V EU)

Emery Allen 4.5W G8 240V Bulb

### LAMP QUANTITY

5

### BRIGHTNESS

2250 Lumens

### DIMMING

Universal

### DIMENSIONAL DRAWING

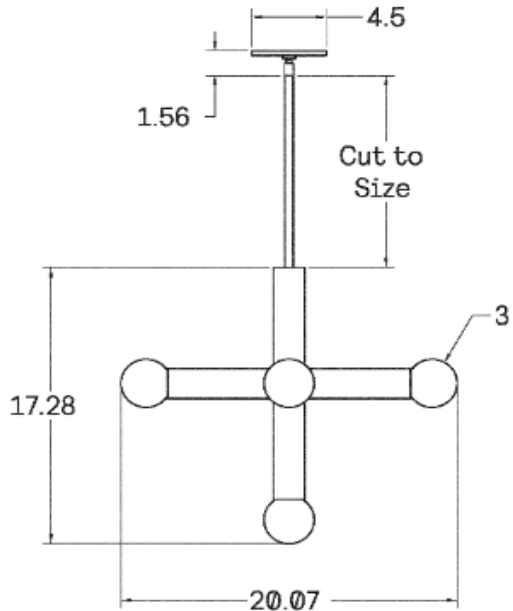

### CERTIFICATIONS

CE, Damp Locations, UL and cUL Certified

